

# MENORAH GARDENS

ON 17th AVENUE, 1/2 MILE SOUTH OF ROOSEVELT ROAD

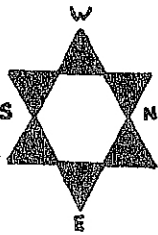
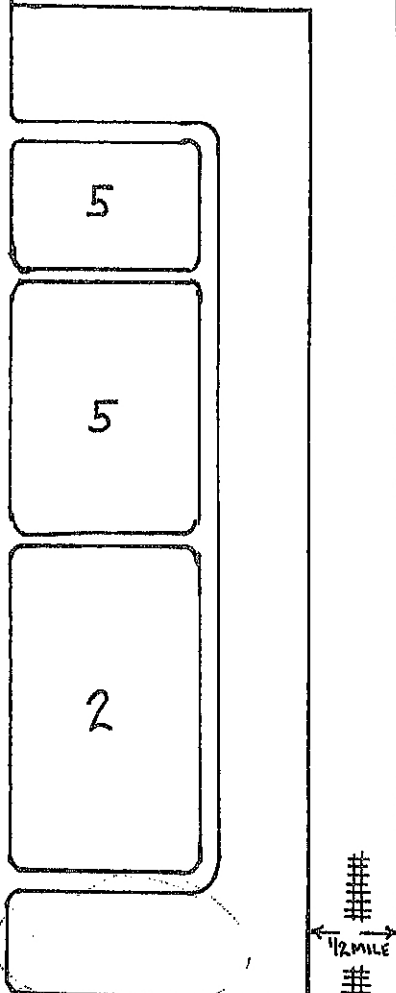
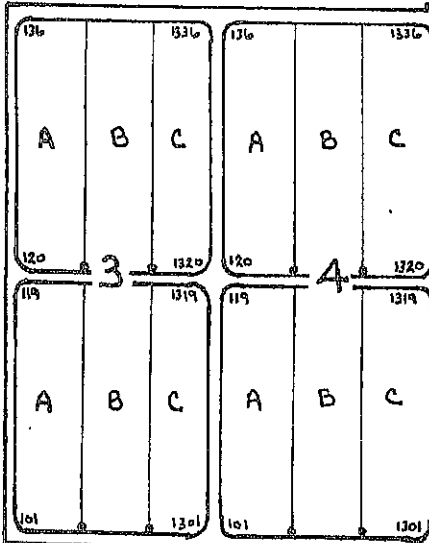

1/2 MILE

1/2 MILE

17TH AVE.

SHOPPING CENTER  
 ARMORY  
 LOYOLA HOSPITAL  
 HINES HOSPITAL

1ST AVE.

JEWISH WALDHEIM  
 MAIN CEMETERY OFFICE  
 JEWISH WALDHEIM

DES PLAINES AVE.

- Agudath Achim Anshei Chattenhom Cong.
- Bollivker (United Aid Society)
- Bogopolier Aid Society
- Brichonner Bessarabier Ass'n.
- Chornigov Progressive Verein
- Czaenkiver & Vicinity Section
- Dubossarrer Dis. Ben. Society
- Graiever Cemetery Ass'n.
- Independent Sick Benefit
- Kremnitzer Benevolent Society
- Lagower Aid Society
- Lohishin Nusach Sfard Delibashon
- Mezeritzer Progressive Society
- Mogelef Podolsk & Vicinity Ass'n.
- Nickolaver Cemetery Ass'n.

Main office located at  
 1400 So. DesPlaines Ave.  
 Forest Park, IL

1/2 mile south of  
 Roosevelt Road



**Waldheim  
 Cemetery Co.**

1400 S. Desplaines Ave.  
 Forest Park, IL 60130-2598  
 1-708-366-4541

22ND STREET

ROOSEVELT ROAD

EISENHOWER EXPRESSWAY

EXIT 17TH AVE

EXIT 17TH AVE